

**CONFIDENTIAL**

THE INFORMATION CONTAINED IN THIS DRAWING IS THE SOLE PROPERTY OF ISIMET, LLC. ANY REPRODUCTION IN PART OR WHOLE WITHOUT THE WRITTEN PERMISSION OF ISIMET, LLC IS PROHIBITED.

NAME ISIMET Commercial Kitchen Drawing (KLA)		TOLERANCE UNLESS SPECIFIED	SCALE 1:4	ISIMET MAPA	PART NO. <b>KLA</b>
FOR ISIMET Specifications		DECIMALS: TWO PLACE ± THREE PLACE ±	CAD NUMBER		
		FRACTIONS: ±	REVISION		
		ANGLES: ±°	BY CH EC DATE		
		SURFACE TEXTURE √	A CREATED DRAWING GY 02/11/2020		
			B		
			C		
			D		

**KLA-HV (120VAC)**

**Inputs (Voltage-Free):**

- Gas Detector (+24VDC Output)
- Carbon Monoxide (+24VDC Output)
- Energy Management System/BMS
- Building Alarm
- Emergency Button
- Fan Interlock

**Outputs:**

- Circuit #1 (120VAC, 2A)
- Circuit #2 (120VAC, 2A)
- Panic (24VDC, 0.25A)
- Panic (Dry-Contact)

Dedicated 120V, 15A

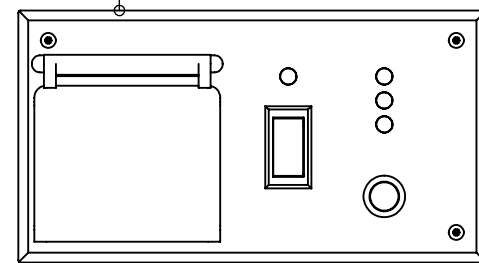

Clear Cover (Default)

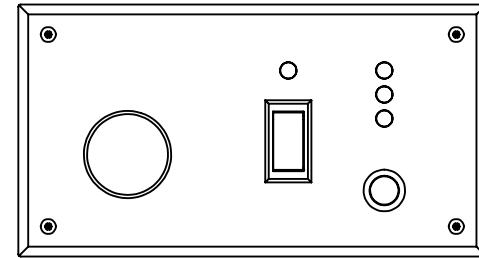

w/o Clear Cover

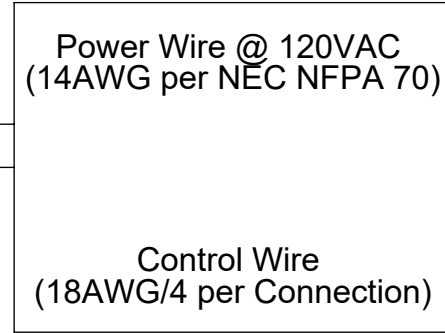

Power Wire @ 120VAC  
(14AWG per NEC NFPA 70)

Control Wire  
(18AWG/4 per Connection)



**OPTIONAL**

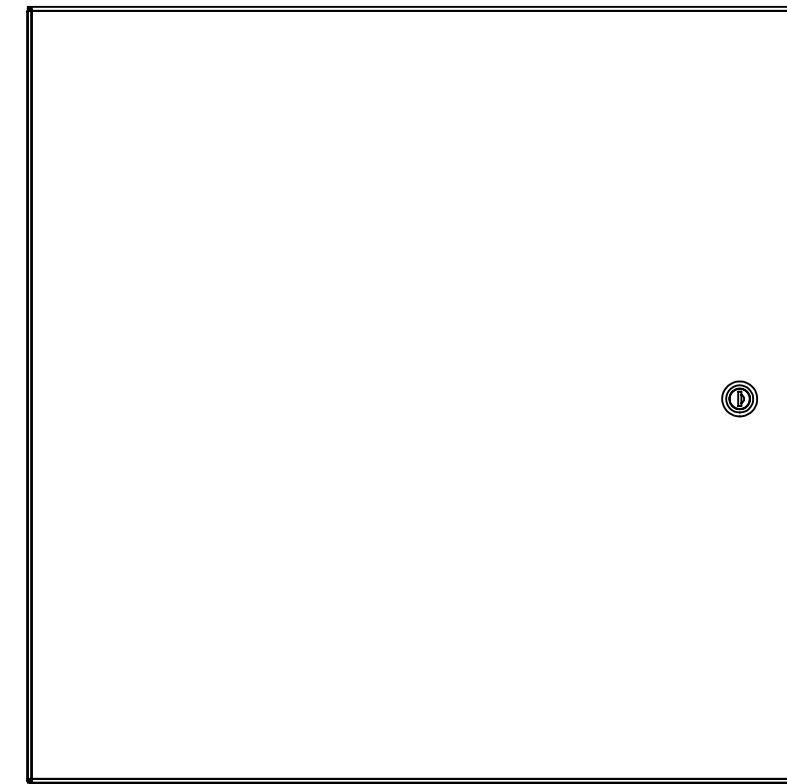

**ISIMET S-Series\*** \*Scale: 1:6

- Comes in multiple sizes. Typically includes the following:
- Gas Solenoid(s)
  - Unions
  - Ball Valve

**OPTIONAL**

Detects leaks in gas line prior to startup.

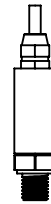

**Gas Pressure Transmitter**  
(Installed in S-Series)

**KLA-LV (24VDC)**

**Inputs (Voltage-Free):**

- Gas Detector (+24VDC Output)
- Carbon Monoxide (+24VDC Output)
- Energy Management System/BMS
- Building Alarm
- Emergency Button
- Fan Interlock

**Outputs:**

- Circuit #1 (24VDC, 1.25A)
- Circuit #2 (24VDC, 1.25A)
- Panic (24VDC, 0.25A)
- Panic (Dry-Contact)

Dedicated 120V, 15A

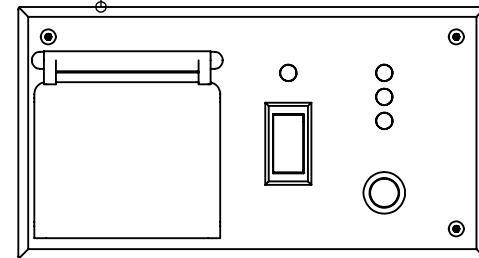

Clear Cover (Default)

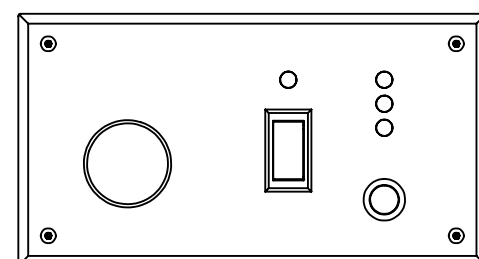

w/o Clear Cover

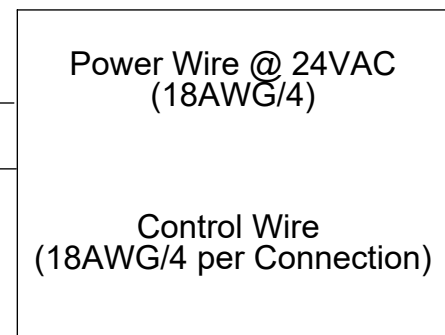

Power Wire @ 24VAC  
(18AWG/4)

Control Wire  
(18AWG/4 per Connection)

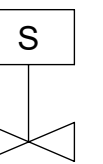

Exhaust Fan  
(Not provided by ISIMET)

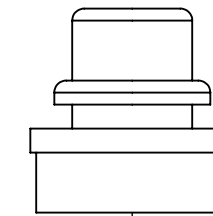

**OPTIONAL**

Fan Interlock:  
Disables the gas when the exhaust fan is turned off.

**OPTIONAL**

Adjustable PPM Gas Detector.

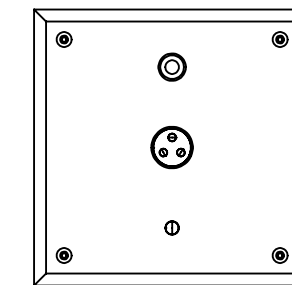

**ISIMET Fuel Gas Sensor (FGS)**

**OPTIONAL**

N/O Panic Button

Multiples can be installed and wired in parallel.

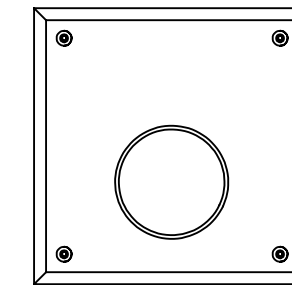

**ISIMET Panic Button (IPO)**

**OPTIONAL**

Monitor Beacon will flash upon Local Emergency.

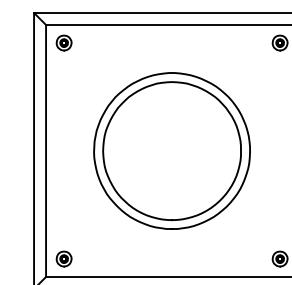

**ISIMET Monitor Beacon**

**OPTIONAL**

-SV (Split Voltage)  
Combines 120VAC and 24VDC control to the KLA-LV

